



■ All Entry points and Exits points must be cleared at all times,

■ Fire Extinguishers and hoses

■ No Items to be affixed to any walls or fixtures

■ Any external electrical equipment being brought into the Melbourne Town Hall must be tested and tagged

■ No external catering is to be brought into the venue

**Safety is a priority at all times**

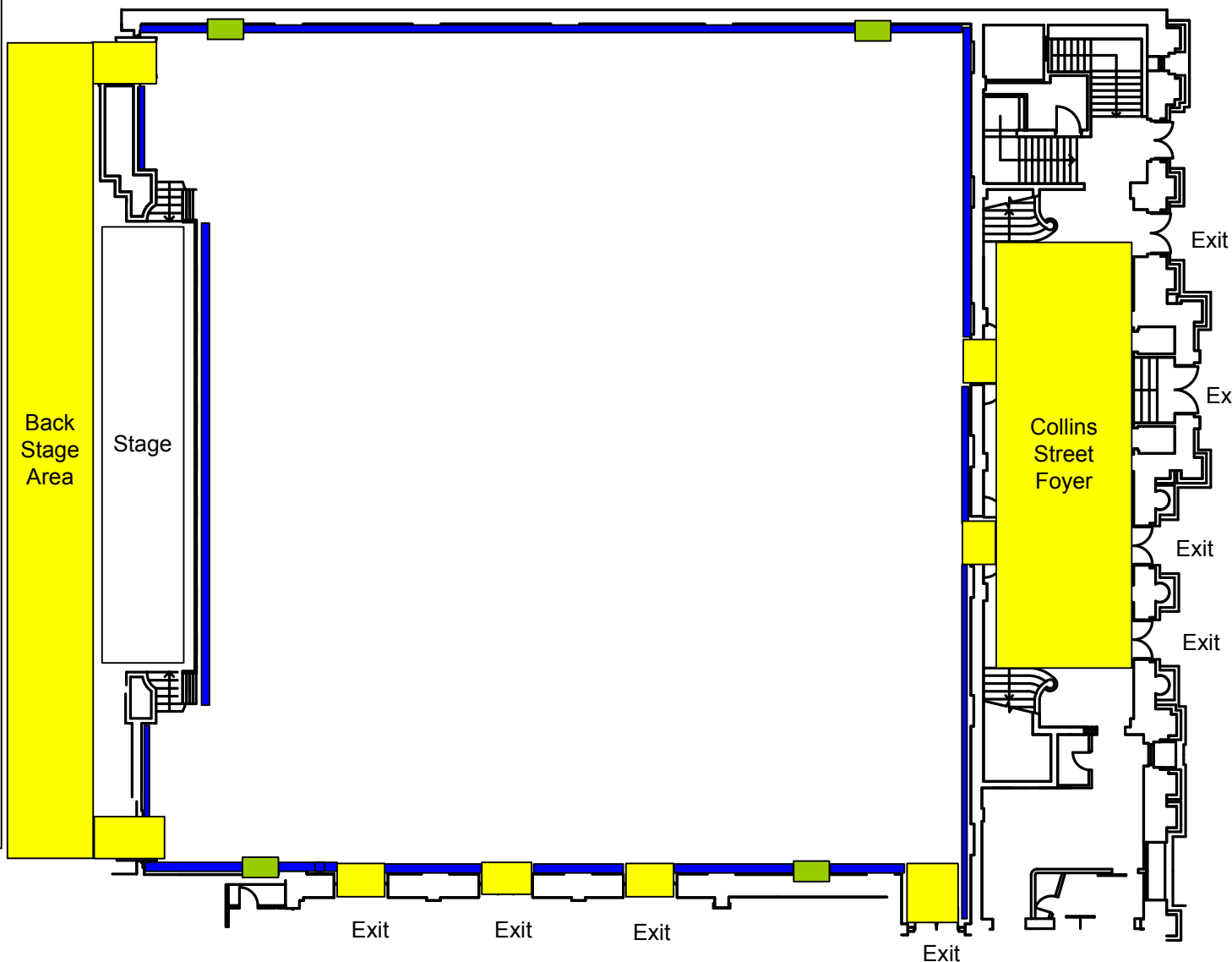

Main Hall Dimensions  
32.5(L) x 33(W) x 20.4(H)

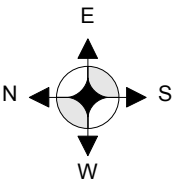
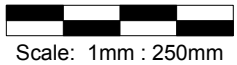
	Client:	Occasion:	 
	Contact:	Guest No.:	
	Venue: Main Hall - First Floor	Date:	